

JUUNOO

**GENERAL
INSTALLATION METHOD**
using BaseClick panels

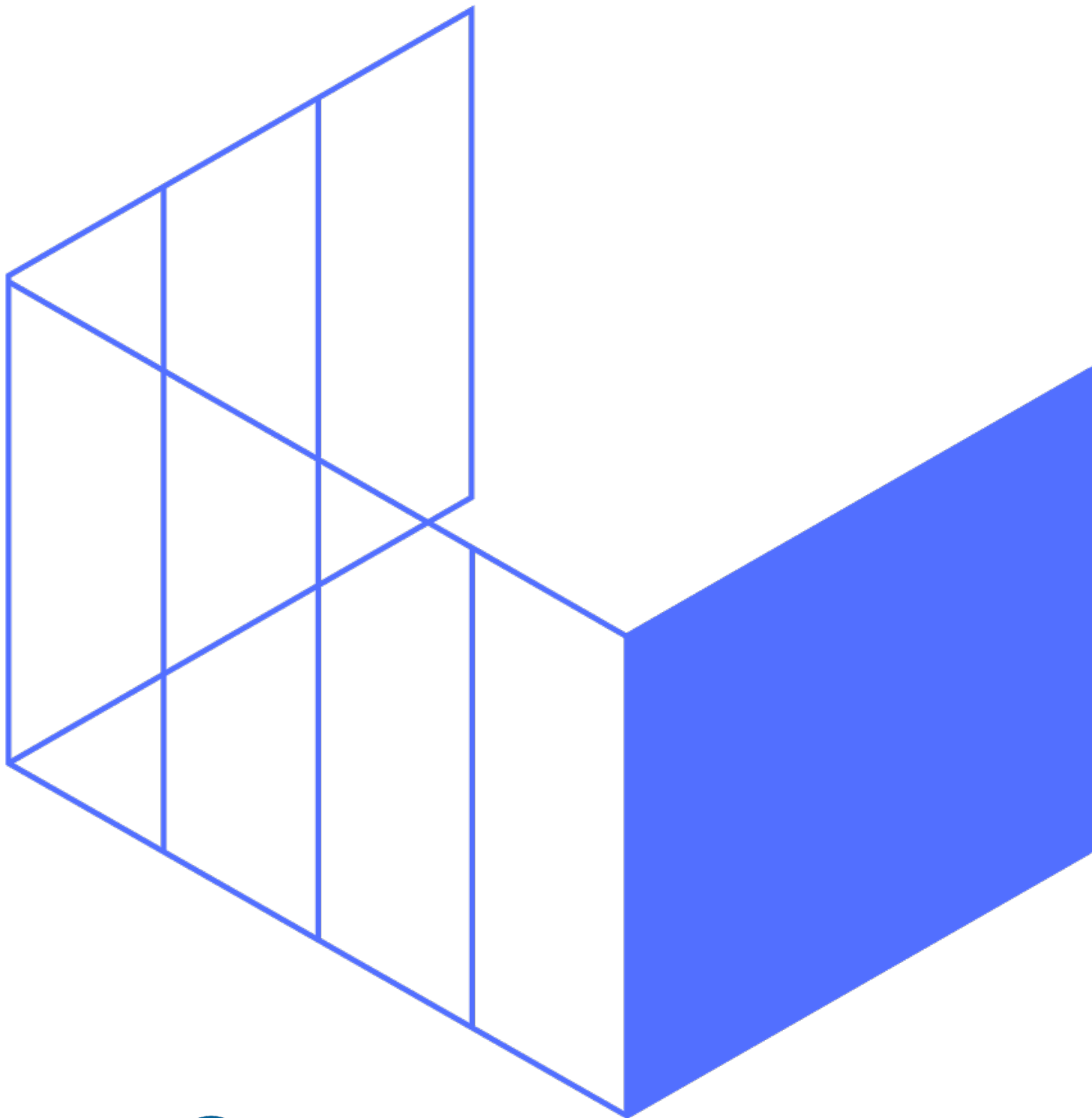

reddot winner 2020





Place the laser on the centre of the wall.



Place the first I-module.

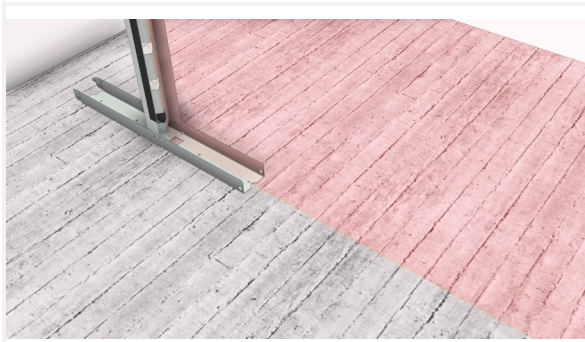

Centre the horizontal and vertical profile on the laser. Fix this module.



Align the second module with the first.



Snap the modules together and centre the end in line with the laser. Fix it.



Continue this across the wall using I-modules.



Remove the laser and fix the C-modules.



Fix all the modules.



Saw the first panel to the right size and glue it, perfectly vertical, onto the modules.



Hook the 2nd panel into the first at 30°. Move the panel forwards and backwards until it clicks.



Press the panel firmly onto the JUUNOO tapes.

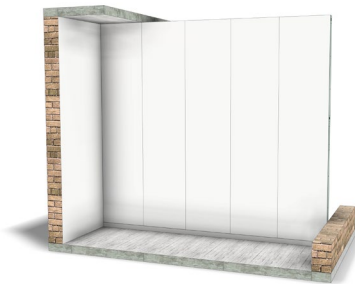

Put the rest of the panels in place. Use an extra strip of JUUNOO tape for the last panel.